

- ZIPPO -

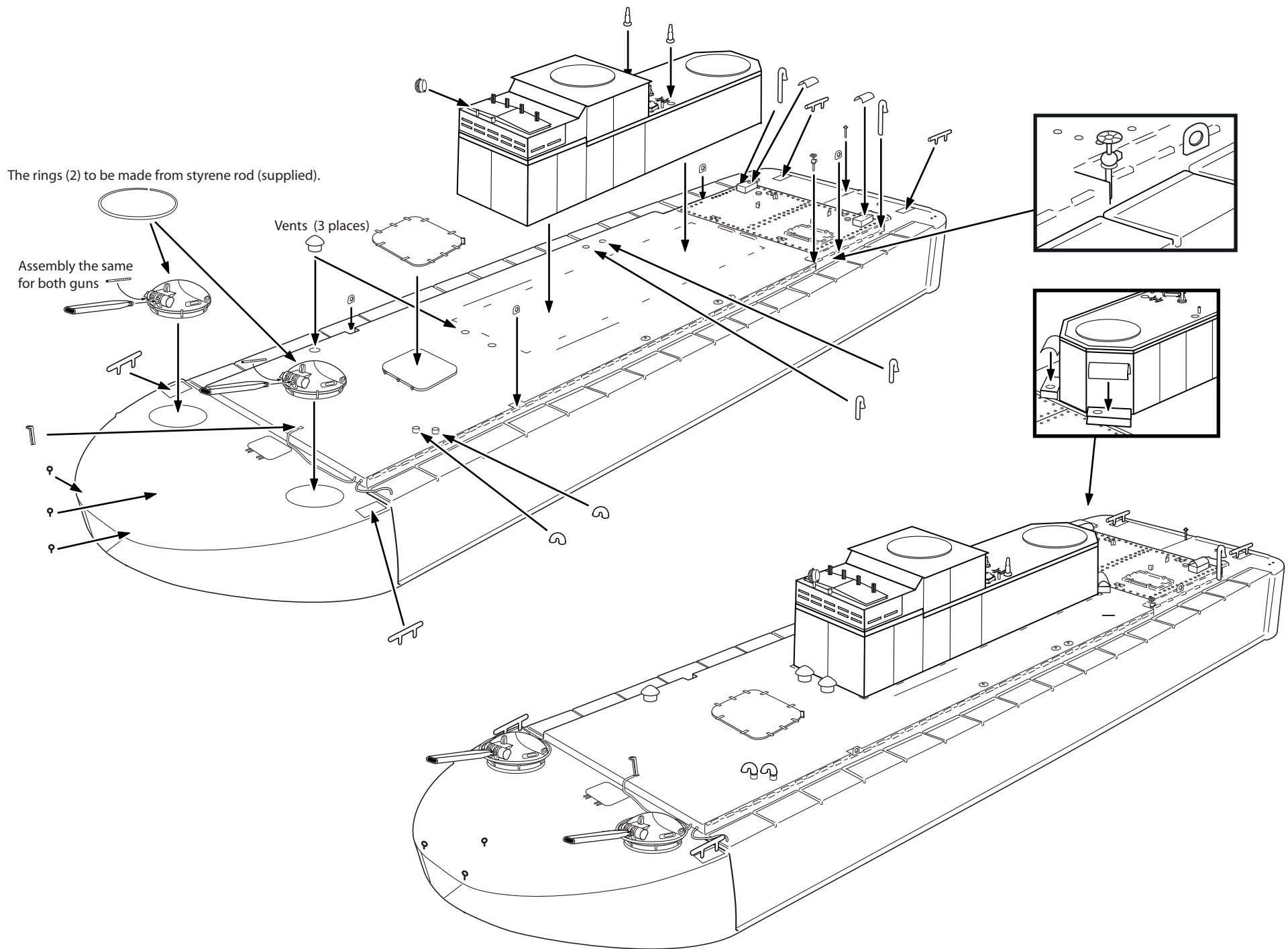

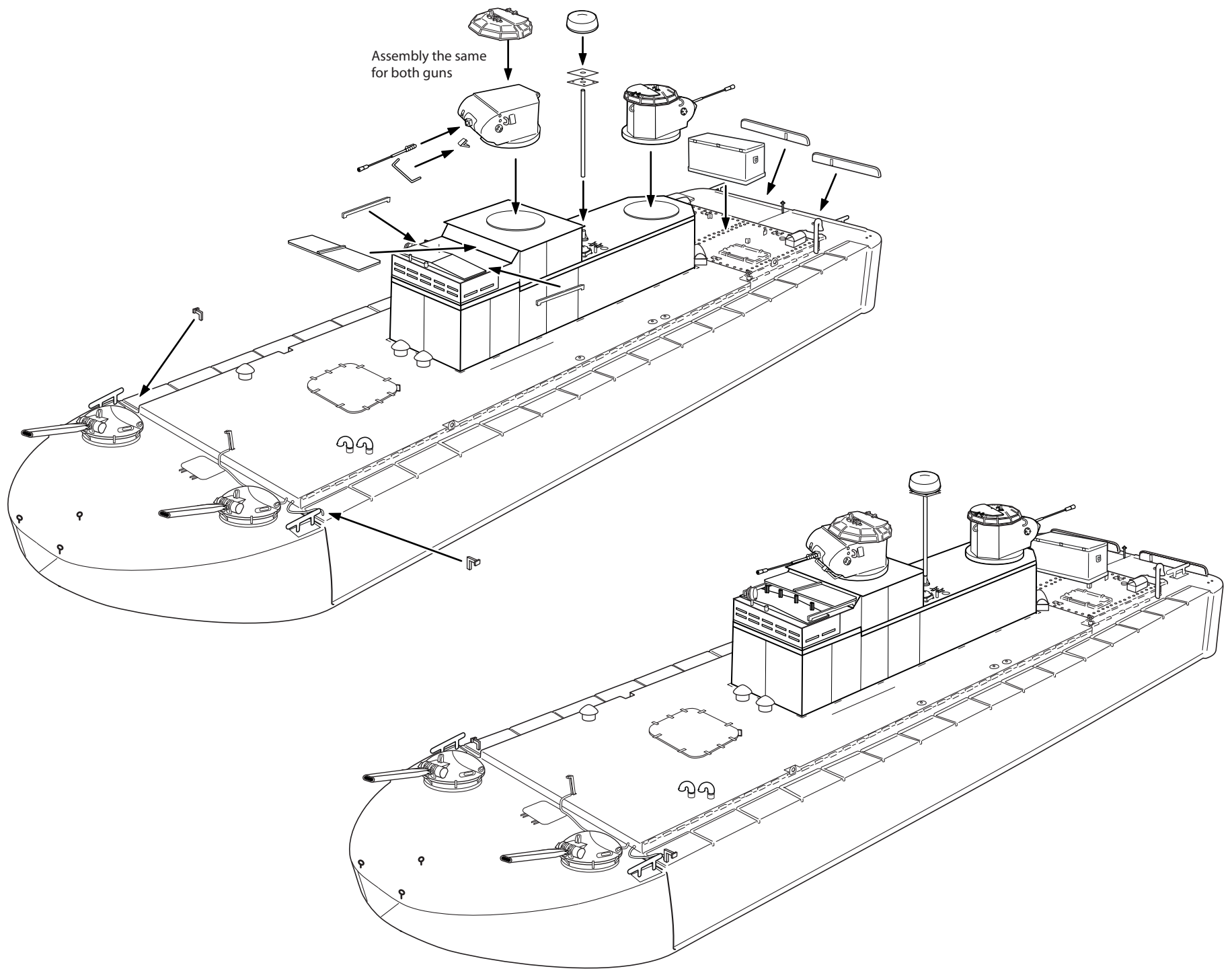

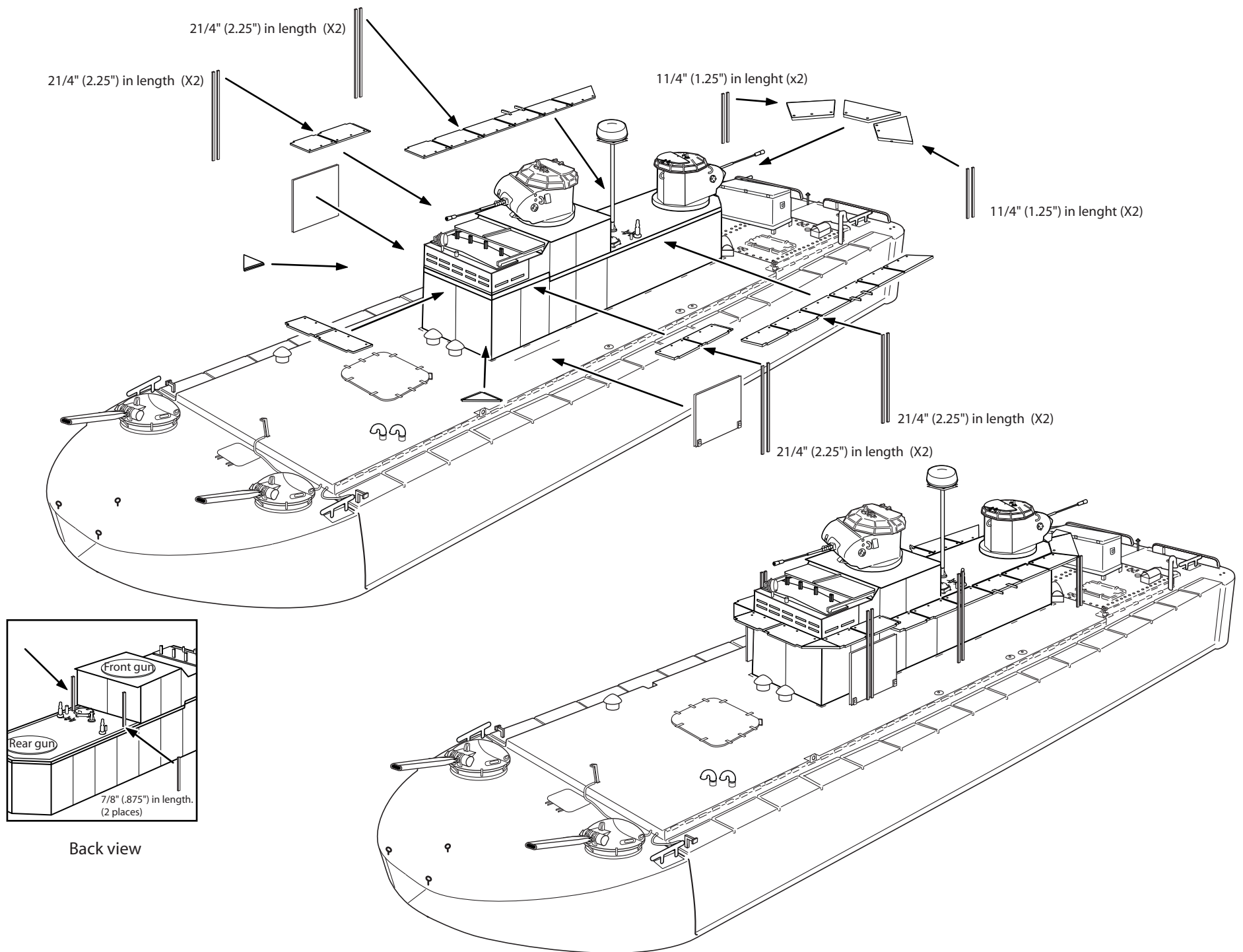

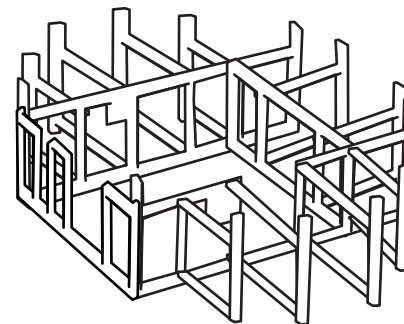
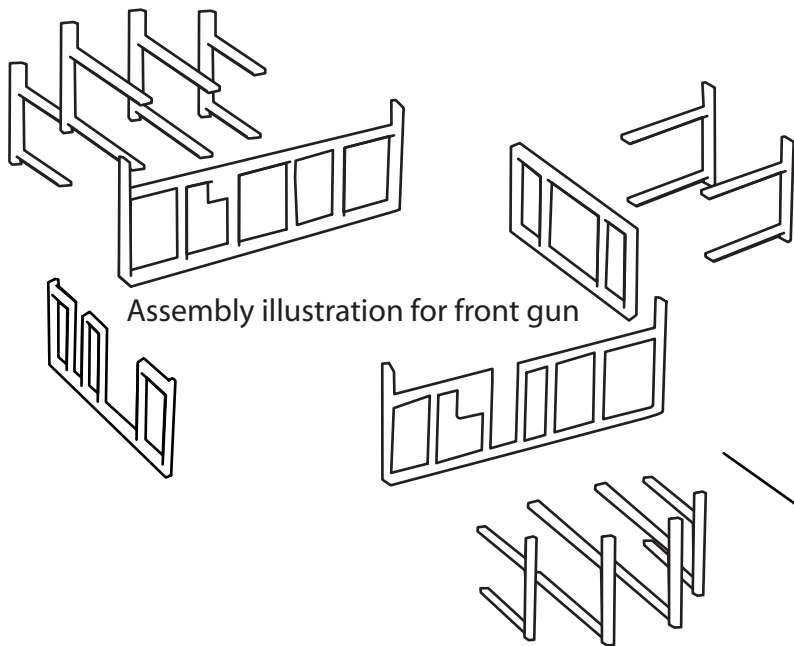

Assemble gun cage around the gun.
Don't assemble gun cage first
Assembly the same for both guns

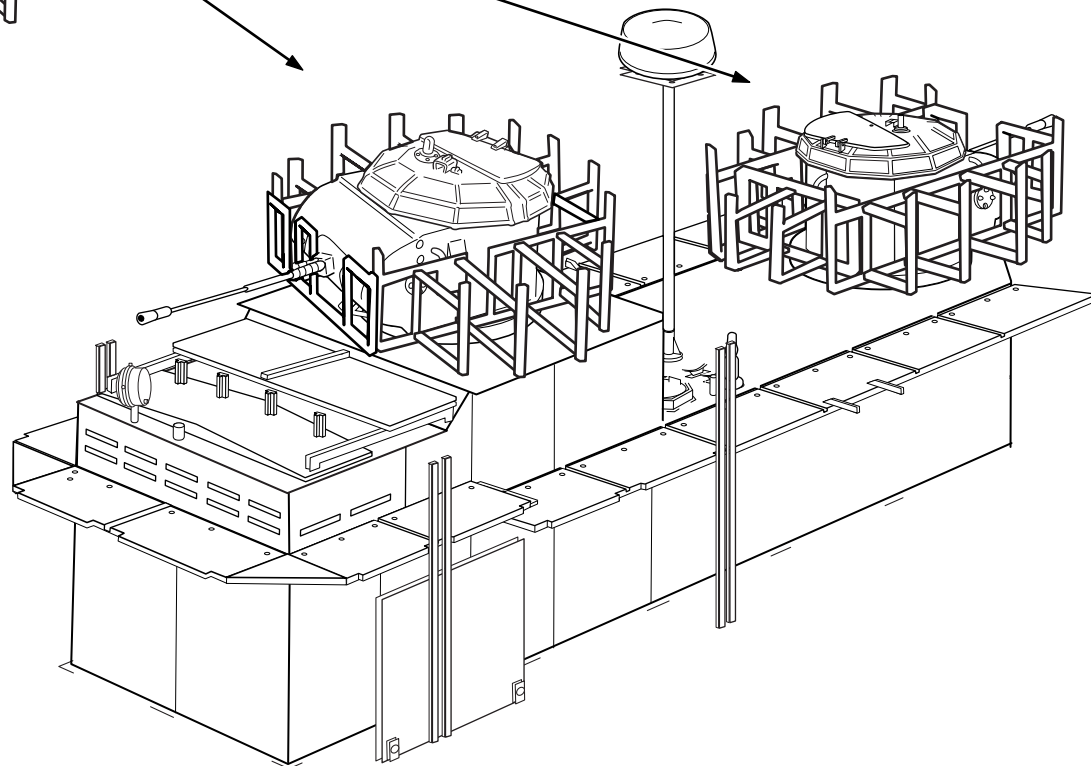

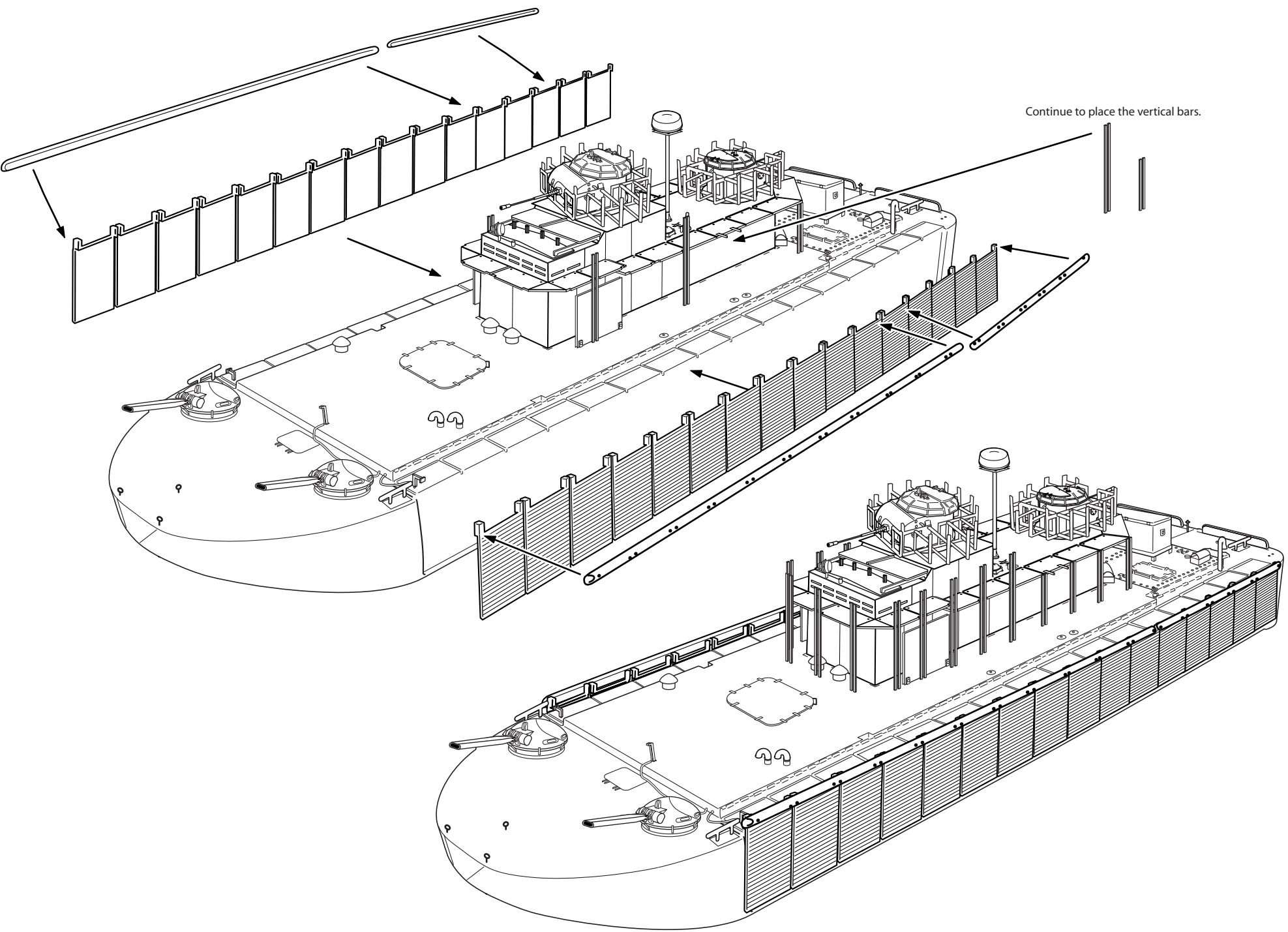

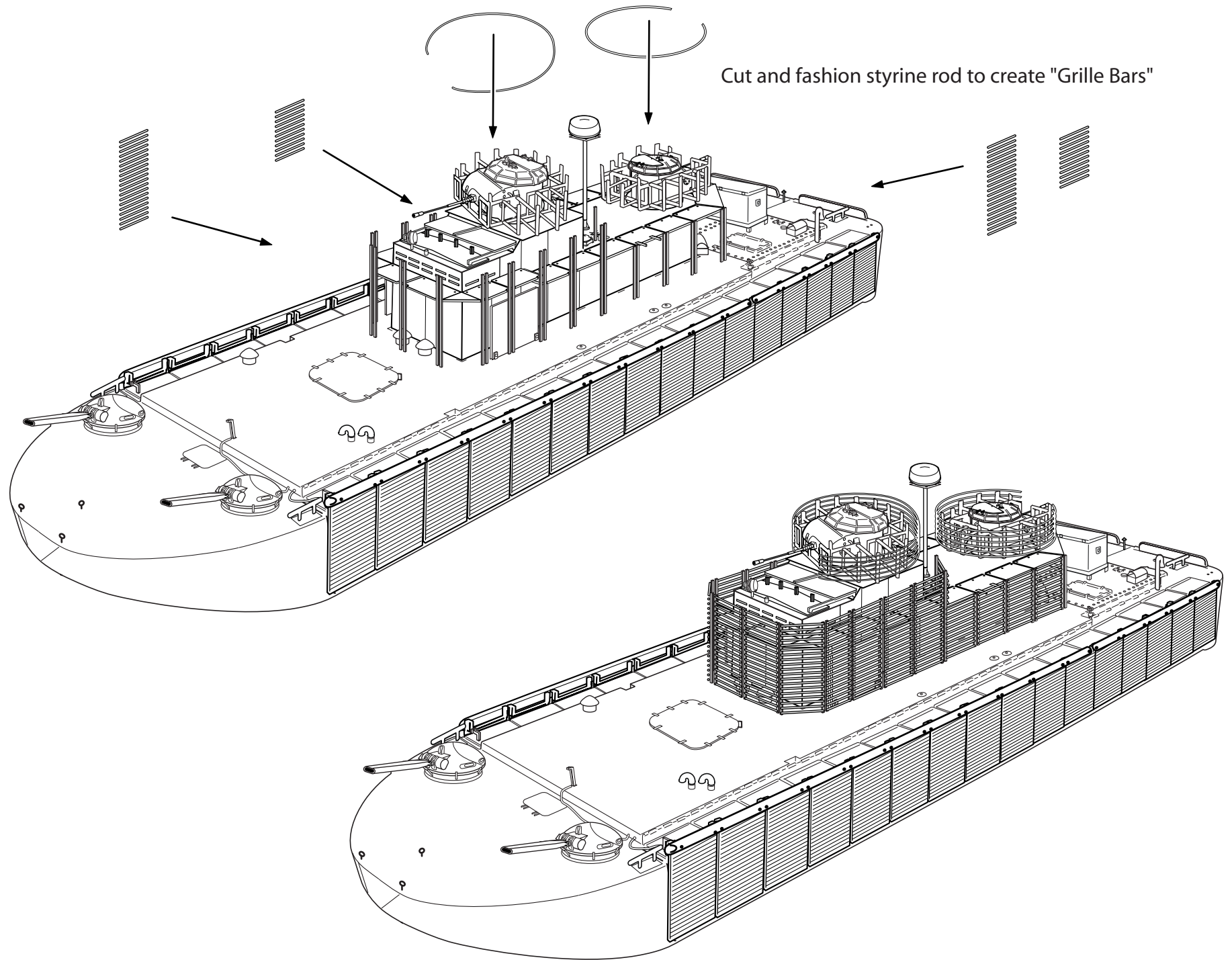

Cut 2 styrene pieces at 5" long and attach them to the posts on the middle deck.

Build this mast (4" piece and 1" piece) from styrene rod and use thread to rig it.

(3 lights) - Assemble and attach to back side of grille bars.

(2 handles) - Attach to front side of grille bars.

Back side

Attach 8 vertical "Bumpers" on the port side only.